



**METAMOB**

passion for bandsaw blades



# Passion for bandsaw blades

Our company is one of the leading manufacturer of saw blades and frame saw blades in Europe. The company has developed its own distribution network and also provides after sales maintenance services for all the offered blades. We provide full technical assistance for the proper use of our products, bringing more efficiency in the activity of our partners by extending the life period and the operating time of their equipment.

Our business activity could be divided into three main areas, namely: production, services and trade.

The first area covers the production of band saw blades for logs, band saw blades for mobile sawmills, narrow band saw blades and frame saw blades.

The service activity comprises all the maintenance services for the saw blades, full technical assistance for our customers regarding the proper use of all our products, and the shape rectification work for the flywheels of the saws, ensuring thereby their efficient use.

Our company also sells other products required by the primary and secondary wood processing industry, such as circular saw blades, planer and jointer knives, various accessories and more.

## Vision

Our vision is to become a reliable partner for various wood processing companies, by delivering flawless products and services through an international network of reliable sales and service partners.

## Mission

Our mission is to increase the profitability of companies working in the field of woodworking industry by offering products, bandsaw blades and frame saw blades, of the highest quality and providing maintenance services at a reasonable price.



# High quality services

Our company offers [professional and high quality services](#) for bandsaw blades maintenance:

## Technical assistance

During a technical assistance session we verify and check both the customer's band saw blade and the maintaining machinery, so that we can come up with the best recommendations regarding operating and maintenance modes.

## Full maintenance of saw blades

Proper operating with band saw blades for cutting logs require special attention to blades preparation and their action during the cutting process.

## Welding

We offer welding services for new band saw blades (for endless blades) ordered from our company, used (with or without teeth) blades, and bimetallic saw blades.

## Tensioning

After a proper dimensional design, tensioning is the main operation and factor that determine a high efficiency of band saw blades during work.

## Levelling

Levelling is an operation that belongs to general blade maintenance, aiming the removal of local defects from the blade surface, such as concave or convex deformations.

## Saw setting

Our company offers setting services as a part of the complete maintenance of new and used blades or for the reconditioning of the blades that are currently in use.

## Toothing

The active (toothed) parts of the saw blades are realized through toothing operations.

## Sharpening

Our company performs sharpening operations both for brand new saw blades and band saw blades that are currently in use.

## Hardening

We offer hardening services as a part of the complete maintenance of new and used blades or for the reconditioning of the blades that are currently in use.

## Stellite-tipping

Our company provides stellite services both for new band saw blades and used blades with worn stellite layer.



# Performance in cutting with universal blades

Standard bandsaw blades specially designed for cutting logs efficiently in high quality conditions.

- ensures good productivity
- high durability – long cutting time because the material keeps it's tensioning and cutting edge for a longer period
- easy maintenance due to the materials good behaviour under the process of swaging and tensioning
- good quality/price ratio

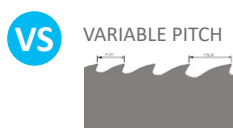

width	thickness	availability
60	1	•
	1,1	•
70	0,9	•
	1	•
80	0,9	•
	1	•
	1,1	•
90	0,9	•
	1	•
	1,1	•
100	0,9	•
	1	•
	1,1	•
	1,2	•
	1,25	•
110	1,1	•
	1,2	•
	1,25	•
120	1,1	◦
	1,2	•
130	1,1	◦
	1,2	•
	1,25	•
140	1,2	•
150	1,2	•
152,4	1,06	•
155,6	1,1	•
	1,25	•
	1,47	◦
181	1,25	•
	1,47	•
206,4	1,47	•
	1,65	◦
260,4	1,47	•
	1,65	•

• - available

◦ - available for order



# Performance cutting for high demands

Superior-quality bandsaw blades for high-quality cutting of logs in sawmill conditions.

- ensures a high productivity
- very high durability (longer cutting time between two sharpenings)
- high resistance (due to it's high content of Ni, it has a higher resistance for repetitive bonding on the flywheel without cracking)
- the bandsaw blade keeps well it's tensioning during the cutting
- lower sensibility to the technical condition of the sawing machine

width	thickness	availability
100	0,9	•
	1,1	•
110	1,1	•
	1,2	•
120	1,1	◦
	1,2	•
130	1,1	◦
	1,2	•
140	1,2	•
150	1,2	•
155,6	1,25	◦
	1,47	•
181	1,25	•
	1,47	•
206,4	1,47	•
	1,65	◦
231	1,47	◦
260,4	1,47	•
	1,65	•
311	1,83	◦

• - available

◦ - available for order

**S** STELLITE-TIPPING

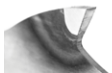

**T** FLATTENING



**VS** VARIABLE PITCH



**DD** DOUBLE-SAW TOOTHED FOR BIDIRECTIONAL CUTTING



**PVDG** DOUBLE-SAW TOOTHED FOR SAWDUST REMOVAL

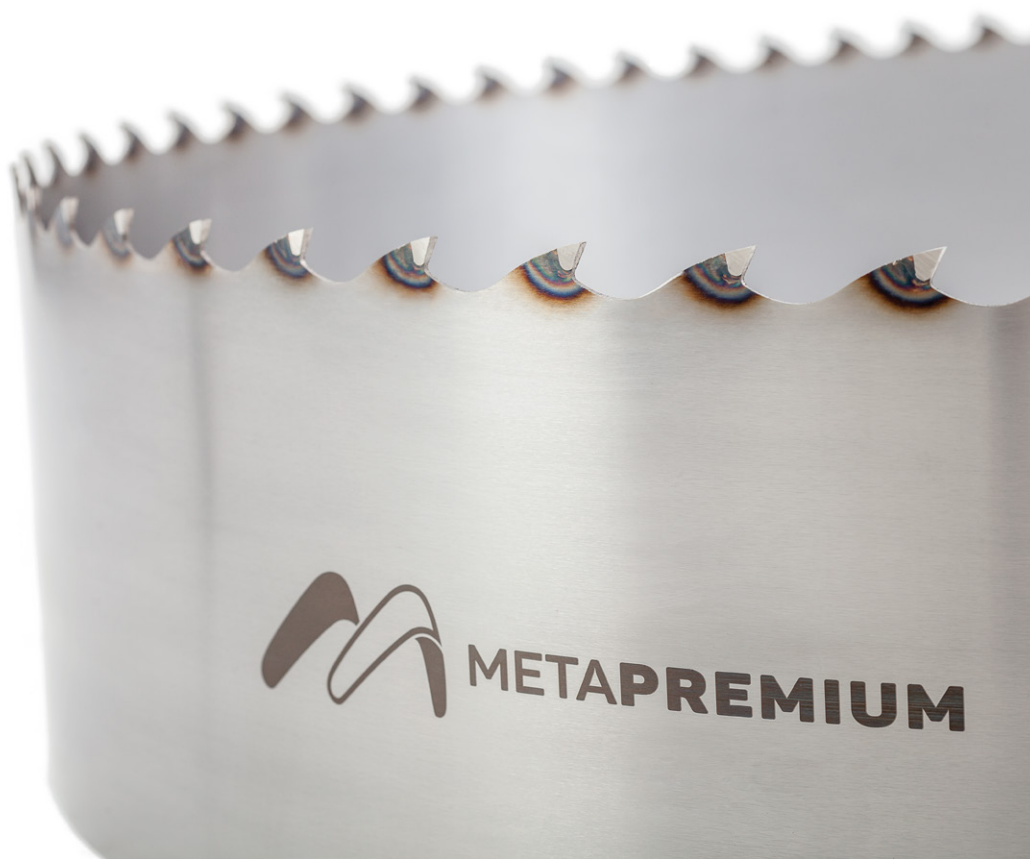

# The guaranteed precision in cutting

Bandsaw blades designed for woodworking and timber factories in order to cut quality veneer and wood slides in a highly precise and efficient way

- ensures a very precise cutting with very small loss of material due to it's high precision technology used in the production method making it ideal for cutting valuable wood
- straight cutting with no fine cracks, guaranteed



width	thickness	availability
60	0,8	•
	1	•
80	0,9	•
	1	•
100	0,8	•
	0,9	•
	1	•
	1,1	•
110	1,1	•
	1,2	•
120	1,1	◦
	1,2	•
130	1,1	◦
	1,2	•
140	1,2	•
150	1,2	•
155,6	1,25	◦
	1,47	•
181	1,25	•
	1,47	•
206,4	1,47	•
	1,65	◦
231	1,47	◦
260,4	1,47	•
	1,65	•
311	1,83	◦

- - available
- - available for order



# Bandsaw blades for mobile milling machines

- good quality/price ratio
- high durability
- stability in cutting

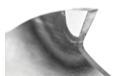
**S**
**STELLITE-TIPPING**

**TT**
**VARIABLE PITCH**

width	thickness	availability
33	1	•
	1,1	•
38	1	•
	1,1	•
43	1	•
	1,1	•
70	1	•
	1,1	•
80	1	•
	1,1	•

• - available

◦ - available for order





## We offer

- High Quality Products at Reasonable Prices
- Reliability and Performance of Products
- A Trustworthy and Dependable Supply Partner
- The Unique Ability to Solve Application Specific Needs

## We are best defined by what our customers say

*"Using blades recommended and manufactured by Metamob company, we have managed to keep production running even in winter at very low temperatures."*

**Eickhoff Otger**  
Technical Officer (Manager)  
at Sägewerk Carl Leiß- Germany

*"In Metamob we have finally discovered a trustworthy supplier with qualitative products. Delivery deadlines have been always respected. The blades are first class, perfectly planned and tensioned. We are fully satisfied. In this way we can subsequently supply our clients with qualitative products."*

**Toni Braunwalder**  
Administrator  
Braumwalder Mobil Sagerei Ag- Switzerland

## Short history

Our company was founded in 1994 in order to meet the demand for wood working tools by delivering its products on the market.

Beginning with our desire to offer high quality products at an affordable price and with good delivery times, in 1997 we started to produce various band saws and frame saw blades.

We are extending our business continuously and now we export our products in countries like: Austria, Belgium, Bulgaria, France, Germany, Hungary, UAE, Ucrain, USA, Slovenia and Switzerland.





# METAMOB

passion for bandsaw blades

440122, Satu Mare  
Str. Aurel Vlaicu 102-106  
Romania

**Tel.** +40 261 706603  
**Fax.** +40 261 710313  
**E.** [sales@metamob.ro](mailto:sales@metamob.ro)  
[metamob@metamob.ro](mailto:metamob@metamob.ro)  
[www.metamob.ro](http://www.metamob.ro)  
[www.facebook.com/metamobsrl](https://www.facebook.com/metamobsrl)